

opk Spaceship 120 G Pocket



Technische Zeichnung

Technical drawing / Plans et schémas

Einfach rein - raus!
Easy in - out!
Entrer et sortir
sans problèmes!

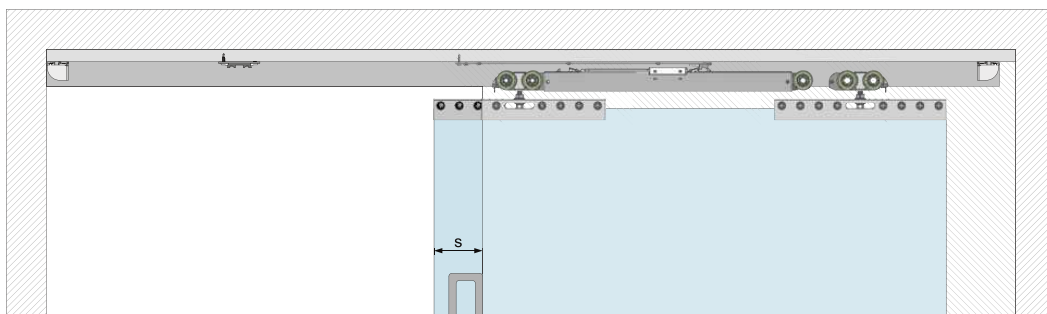
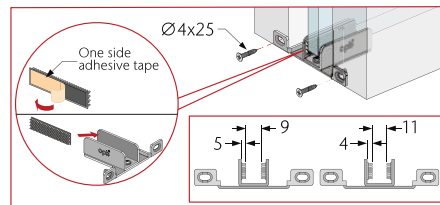
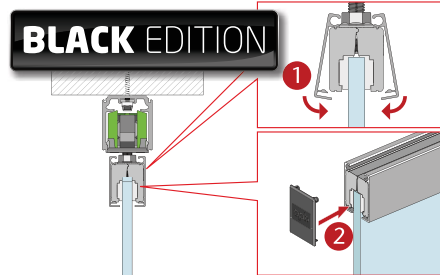
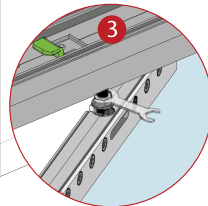
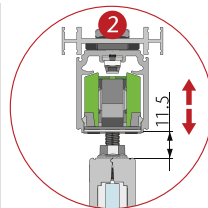
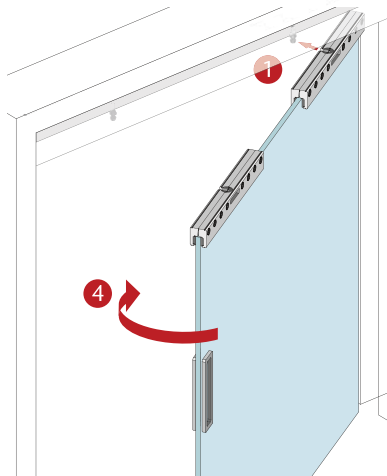
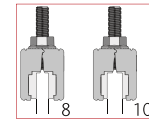
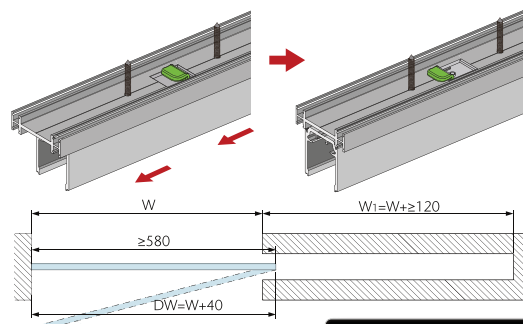
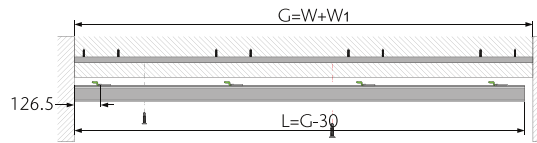
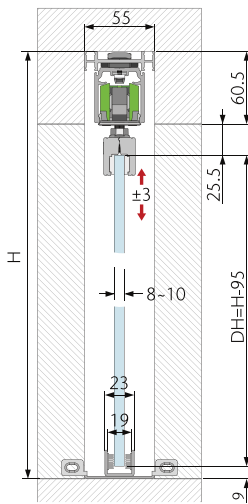
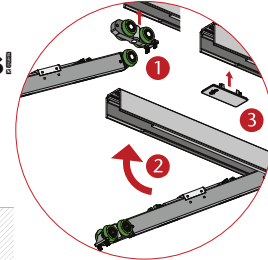

opk Spaceship 120 G Pocket



Art.-Nr. /
No. / N° d'art.

		≤120	≥800	03-011-160-104
--	--	------	------	----------------

Konfiguration für 1 Tür

Configuration for 1 door / Configuration pour 1 porte



Laufwerk mit 2-Wege Dämpfer <i>Running part with two-way damper / Train de roulement avec amortisseur 2 voies</i>		1
Laufwerk <i>Running part (roller) / Train de roulement</i>		1
Aktivator lang <i>Activator long / Activateur long</i>		1
Aktivator <i>Activator / Activateur</i>		1
Klemmschuh Glas 8/10mm <i>Glass clamp 8/10mm / Cosse de serrage verre 8/10 mm</i>		2
Endstopper <i>End Stopper / Butée d'extrémité</i>		2
Bodenführung Pocket Glas inkl. Filz <i>Floor guide pocket glass incl. fleece / Guidage au sol verre, feutre compris</i>		1
Abdeckung für Revisionsöffnung <i>Cover for revision notch / Cache pour ouverture de révision</i>		1
Zubehörset Holz <i>Accessories wood / Set d'accessoires bois</i>		1